

ENTRY METHOD: FIRST RECEIVED

ENTRIES WILL OPEN **June 16, 2017** at 8:00 a.m. at the Trial Secretary's address. All entries received before this date will be returned. Overnight or certified mail must be sent with the "No Signature Required" waiver signed.

ENTRIES CLOSE ON **August 25, 2017** at 6:00 p.m. (Minimum of 14 days prior to the start of the trial) after which time entries cannot be accepted, cancelled, altered, or substituted except as provided for in Chapter 11, Section 6 of the Rules Applying to Dog Shows. Envelopes/transactions containing entries for more than the ten (10) dog maximum and/or entries received prior to the opening date shall be treated as an invalid entry and shall be returned to the sender.

PREMIUM LIST
AKC All-Breed AGILITY TRIALS
**Open to All AKC-Recognized Breeds and
All-American Dogs/Mixed Breed Dogs Listed
In the AKC Canine Partners ProgramSM**

Peoria Obedience Training Club



Licensed by the American Kennel Club

Sept. 8, 2017 Event # 2017014010

Sept. 9, 2017 Event # 2017014011

Sept. 10, 2017 Event # 2017014012

Avanti's Dome & Sports Center

3401 Griffin Avenue
Pekin, IL 61554

ENTRY LIMITS

Friday, Saturday & Sunday – 330 runs per judge for a total of 660 runs per day

Indoors on Soccer Turf – both rings are 110x110

RUBBERIZED CONTACTS IN BOTH RINGS

Trial Hours: Friday, Saturday & Sunday – 7:00 am to one hour after last run

Judges:

Peter Liu #15833, VMO

Michele Fletcher #90966

**Amended
Event Committee!**

CERTIFICATION



Permission is granted by the American Kennel Club for the holding of this event under American Kennel Club rules and regulations.

James P. Crowley, Secretary

OFFICERS OF THE PEORIA OBEDIENCE TRAINING CLUB

President.....Paul Mooney
 Secretary.....Jill Williamson
 Vice President.....Linda Brillon
 Treasurer.....Deyonne Hinderliter

TRIAL CHAIRPERSON

Roxanne Minor
 3317 E Alvard Ln
 Chillicothe, IL 61523 - 309-678-7398
RoxMinor1@Frontier.com

TRIAL SECRETARY

Le Hayes
 10800 W. Brimfield Jubilee Road
 Princeville, IL 61559
 309-243-8652
LeHayes3@aol.com

Assistant Trial Chairperson

Nancy Affolter -208 Burning Tree Dr - Pekin IL 61554 - 309 992-8700 - bhanancy@hotmail.com

EVENT COMMITTEE

Diane Bader, Linda Doerfler, Vickie Gordon, Paul & Peggy Mooney, Le & Nancy Hayes
 Hospitality ... Nancy Affolter
 Public Relations ... Linda Locke

JUDGES AND ASSIGNMENTS

Michele Fletcher, #90966
 12080 Old St. Highway 28
 Pikeville, Tn, 36367

Peter Liu, #15833, VMO
 12771 SW 147th St
 Miami, Fl 33186-6302

Friday – Ring 1
 Saturday - Ring 2
 Sunday - Ring 1

Friday – Ring 2
 Saturday Ring 1
 Sunday Ring 2

VETERINARIAN ON CALL (OR IN ATTENDANCE)

Tri-County Animal Emergency Clinic
 1800 N Sterling Ave
 Peoria, IL 61604
 309-672-1565

EMERGENCY SERVICES - Tazwell County - 911

CLASSES OFFERED AND START TIMES

Friday, Saturday and Sunday

Ring One 7:30 am
 T2B

Standard –
 Premier
 Masters/Excellent
 Open
 Novice

Ring Two- 8:00 am

FAST – Novice
 Open
 Master and Excellent

JWW – Novice
 Open
 Excellent/Masters
 Premier JWW

Please consult the AKC Regulations for Agility Trials for a complete description and eligibility for entry into these classes. The exhibitor is fully responsible for entering the dog in the correct class(es)/height divisions. Dogs running in a lower height division than they are eligible for will be eliminated.

HEIGHT DIVISIONS

REGULAR

Handlers may opt to run their dog in a higher height division.

8"
 12"
 16"
 20"
 24"
 26"

PREFERRED

Handlers must run their dog in their proper eligible height.

4"
 8"
 12"
 16"
 20"
 n/a

HEIGHT AT WITHERS

Owners are responsible for entering their dog in the proper height division.

For dogs 11 inches and under at the withers
 For dogs 14 inches and under at the withers
 For dogs 18 inches and under at the withers
 For dogs 22 inches and under at the withers
 For dogs over 22 inches at the withers
 Dogs may be entered at this height at their owner's discretion

MEASURING and HEIGHT CARD INFORMATION

Effective January 1, 2010, exhibitors are no longer required to provide proof to Trial Secretaries that their dog has a valid jump height card as part of the check-in process. Furthermore, this change eliminates the need for a copy of the jump height card to be submitted with an entry form. Dogs without a valid Jump Height Card/Form may still compete; but they must be measured/wicketed by the **Judge of Record** PRIOR to running in their class and this measurement will be valid for that weekend of trials only. The exception to this requirement is a dog entered in the 24" or 26" height division. However, if a **Volunteer Measuring Official (VMO)** or an **Agility Field Rep** is present; ALL dogs without a valid Jump Height Card/Form must be measured at some time during the trial or cluster of trials. This does not preclude having the dog wicketed by the Judge of Record if the VMO or Rep is not available to measure the dog **before** its first run of the trial or cluster of trials. It is the exhibitor's responsibility to have their dog measured prior to running and failure to do so will result in the cancellation of any qualifying scores. There will be a VMO at this trial

NEW Simplified Jump Height Card Process

When filling out the entry form, there is a new section at the top of the form for exhibitors to designate whether your dog needs to be officially measured. Please check the box so that the Trial Secretary knows whether to include your dog on the *Dogs To Be Measured List*. It is no longer required that you submit a copy of your dog's jump height card with your entry form or show it during day of show check-in; although exhibitors are required to have the official form/card with them at the trial to present upon request.

DOG ELIGIBLE TO ENTER

This trial is open to all dogs fifteen (15) months of age or older that are registered with the American Kennel Club or that have AKC Limited Registration, Purebred Alternative Listing/Indefinite Listing Privileges (PAL/ILP), an AKC Canine Partners listing number, or approved Foundation Stock Service (FSS) breeds are eligible to participate.

Dogs with a Purebred Alternative Listing/Indefinite Listing Privileges (PAL/ILP) or an AKC Canine Partners listing number must be spayed or neutered in order to compete. Wherever the word "dog" is used in these regulations it includes both sexes.

Dogs should be physically sound. Dogs that are blind or deaf shall not be eligible, and neither are bitches in season, aggressive dogs, or dogs suffering from any deformity, injury, or illness which may affect the dog's physical or mental performance. No dog shall compete if it is taped or bandaged in any way or has anything attached to it for medical purposes. Refer to Chapter 2 of the Registration and Discipline Rules for the listing of registerable breeds that may participate. Puppies under four (4) months of age are strictly prohibited from the trial grounds.

All exhibitors should obtain a copy of the Regulations for Agility Trials by downloading them from the American Kennel Club website at <http://www.akc.org/rules/>.

OBSTACLES AND RING CONDITIONS

All obstacles will meet the specifications for obstacles in the current edition of the AKC Regulations for Agility Trials. **Rubber contacts will be used for all classes in both Rings.** All classes will take place **indoors** on Soccer turf. Ring size will be 110 x 110. This site is air-conditioned and heated.

ENTRY FEES PER DAY

First entry of each dog (includes a \$3.50 AKC recording fee)	\$25.00
Second entry of same dog (includes a \$3.00 AKC recording fee)	\$15.00
Third entry of same dog (includes a \$3.00 AKC recording fee)	\$15.00
Fourth entry of same dog (includes a \$3.00 AKC recording fee)	\$15.00
Fifth entry of same dog (includes a \$3.00 AKC recording fee)	\$10.00
Sixth entry of same dog (includes a \$3.00 AKC recording fee)	\$10.00

If you would like to know the status of your entry prior to the issuance of the judging schedule upon closing, please enclose a self-addressed, stamped envelope or postcard along with your entry. E-mail confirmations will be sent to those listing a legible e-mail address on the entry form.

Mail entry forms and fees to: Le Hayes, Trial Secretary, 10800 W Brimfield Jubilee Road, Princeville, IL 61559, 309-243-8652. Please make checks payable to **POTC**. No entries will be accepted by phone, or fax. or hand delivery. Express mail entries must include the signature waiver allowing them to be left at the secretary's address. Inquiries may be directed to Le Hayes at lehayes3@aol.com. No entry shall be made and no entry shall be accepted which specifies any conditions as to its acceptance.

Illegible entries will not be processed and will be returned to the exhibitor. Returned checks do not constitute a valid entry and the Treasurer will add a \$20 collection fee to the amount of each returned check.

Peoria Obedience Training Club is accepting online entries through www.labtestedonline.com. During the first 48 hours after opening, the initial limit of entries designated as either online or paper will be as follows: Online entries:: 220; Paper entries: 440. If either form of entry has not filled at the end of the 48 hour time period, the club reserves the right to decrease or increase either the online or paper limit accordingly. No hand deliveries will be accepted in the first twenty-four hours following the opening date and time.

COURSE WALK-THROUGHS AND WARM-UP INFORMATION

Handlers in all classes are permitted to walk the course, without a dog, during a walk-through period held prior to the start of the class. The walk-through is restricted to handlers entered in that class only. Handlers with multiple dogs, at events with multiple rings may request to walk with a height group other than the one their dog is entered in if a conflict is imminent.

A warm-up area, consisting of a regulation agility jump, may be provided for exhibitors. The warm-up area is to be used exclusively for warming up the dog and not for training or relieving of the dog.

RIBBONS AWARDS AND PRIZES

Rosettes will be awarded in each jump height division in each class as follows:
First Place *Blue*
Second Place *Red*
Third Place *Yellow*
Fourth Place *White*
Qualifying Score *Dark Green*

A New Title rosette will be awarded to all dog and handler teams finishing a title. A MACH & PACH rosette and decorated MACH or PACH bar will be awarded to all dog and handler teams that attain their MACH or PACH. Cones will be presented to those dogs attaining their MX/MXP/MXJ/MJP. Double Q ribbons will be awarded. A PAX rosette will be awarded for those achieving their PAX and title cones will be awarded for those receiving their MX, MXJ, MXP or MJP.

SAFETY, BEHAVIOR and LIABILITY

The safety of the dog is our primary concern. By entering this trial, exhibitors acknowledge that they are familiar with the rules and regulations of this sport, and that their dogs are familiar with and able to perform all obstacles safely.

It is expressly understood that exhibitors alone are responsible for the behavior of their dogs and/or children. One exhibitor whose dogs and/or children create an unnecessary disturbance or repeatedly engage in unsafe or disruptive behavior may, at the discretion of the event committee, be asked to leave the show site. In such case, no refund of any fees paid will be made. The Peoria Obedience Training Club (POTC), Avanti's Dome and Sports Center and its agents, employees, etc., will assume no responsibilities for any loss, damage or injury sustained by exhibitors or handlers, or to any of their dogs or property and further assumes no responsibility for injury to children. The Peoria Obedience Training Club reserves the right to decline entries for cause and may remove any dog on account of aggression. No one shall have any recourse or claim against the POTC or any official thereof.

All dogs must be on leash at all times when on trial grounds except when in the designated warm-up area or competing on the course.

REFUNDS

No entry fee will be refunded if the trial cannot open or be completed by reason of riots, civil disturbances, fire, an act of God, public emergency, act of a public enemy, or any other cause beyond the control of the organizing committee. No entry fee will be refunded in the event a dog is absent, disqualified, excused, or barred from competition by the action of the Event Committee.

Bitches in season are not permitted to compete in Agility Trials. As such, the club will refund the full amount of the entry fee paid for bitches and unable to compete for this reason upon presentation of a veterinarian certificate. This certificate must be presented to the Trial Secretary prior to the start of judging on the first day of the trial or cluster of trials.

RINGSIDE

Dogs may arrive any time prior to judging if the dog has a valid temporary or permanent jump height card. Otherwise, they must be available for measuring prior to the start of their class if a VMO or AKC Field Rep is available to measure dogs. All dogs not needed for further judging will be excused.

Judges are not required to wait for dogs. The Owner of each dog is solely responsible for having it ready at ringside when it is to be judged. The Club has no responsibility for providing service through a public address system or stewards or runners for the purpose of calling or locating dogs that are not brought into the ring when required.

CATALOGS

Advance catalog sales may be ordered and prepaid on your entry form for \$6.00 A limited number of catalogs will be available for sale at the trial site for a cost of \$8.00. Running order sheets will be available to all exhibitors at no charge.

VENDORS

If you would like a vendor space, please contact Sande Wilkie at (309) 639-4477 or 309-339-9633 or s.wilkie09@gmail.com for more information.

ADDITIONAL SITE INFORMATION

Crating space: Ample crating will be directly behind the agility rings however, POTC and the Avanti's Dome will not be responsible for any lost or damaged items left at the show site. You can bring your equipment in through the back overhead door entrance. Those doors are to be operated by Avanti's personnel **only**. Front entry through revolving door throughout the day.

A full service food concession is available on the site. The Sports Arena asks that no food be brought into the facility. Dog treats are allowed. There are several restaurants and fast food vendors within a 3 miles driving distance. Worker coupons will be given that you can use to purchase food.

Overnight or RV Parking is available. **PLEASE NOTE:** There is **no electrical service for large motor homes** at this facility RV parking is not restricted to a particular area. Showers are not available onsite.

Exhibitors are responsible for cleaning up after their dog(s). Any exhibitor failing to do so may be excused without benefit of refund if the Event Committee deems the exhibitor to be in violation of this requirement. Cleaning supplies and disposal sites will be available at various locations around the show grounds.

Special arrangements can be made with Roxanne Minor @ RoxMinor1@Frontier.com -309-678-7398 to set up on Thursday, Sept. 7 2017. You must contact her to make arrangements.

The building will be open to exhibitors 6:00 am Friday 9/9/16, Self-service check in will begin at 6:30 all days. Class judging will begin no earlier than 7:30 AM. **Exact running order will be determined after entries close and will be provided in the Judging Program.** There will be one half hour difference in start time between rings. This set of trials uses electronic timers.

Entries will not be accepted without signature, fees and back of entry form with agreement signed, nor will credit cards or faxed entries be accepted. Online entries at www.LabTestedOnline.com are accepted.

POTC and Avanti's Dome & Sports Center will not be responsible for the loss of or damage to any dog exhibited, or for possessions of any exhibitor, whether the result of an accident or any other cause. It is distinctly understood that every dog at this show is in the care and custody of its owner or handler during the entire time the dog is in the trial buildings or on the grounds of the Avanti's Dome & Sports Center. The welfare of an exhibitor's child is assumed to be the responsibility of the exhibitor. It is distinctly understood that exhibitors will exercise control and restraint over their children.

Exhibitors should follow their veterinarian's recommendations to assure their dogs are free of internal and external parasites, any communicable diseases and have appropriate vaccinations.

Exhibitors may wear shirts or insignia of their training group.

HOTEL INFORMATION

These hotels have graciously agreed to accept our well-mannered dogs. A pet deposit may be required. Please check with hotels for policies and restrictions when making reservations. Please tell them you are with the agility trial at Avanti's Dome with POTC.

PEKIN AREA MOTELS

We have arranged for a block of rooms at both facilities. Please reserve a room at least 2 weeks prior to arrival. Be sure to tell them you are going to the dog show at the Dome.

Super 8 * new listing

3830 Kelly Drive
Pekin, IL 61554
Room rate - \$65.59/day
\$10 dog fee per stay

ECONO LODGE SUITES

3242 Vandever Avenue
Pekin, IL 71554
309-353-4047
\$20 for up to 5 dogs per room if you mention POTC

CONCORDE INN

2601 Court Street
Pekin, IL 61554
309-347-5533
\$10 per dog. If 10 rooms are used; the pet fee will be waived

Morton Area Motels (North) I-155 to I-74 East

Approximately 15 miles

Travelodge Morton, Illinois

101 E Ashland Street
Morton, IL 61550
309-266-1600
Pet fee \$5 per dog – non-refundable. Tell them at you are with the dog show and spoke with the manager

Quality Inn

115 E. Ashland Street
Morton, IL 61550
309-266-8310 -Exit 102 off I-74
Pet fee \$5 per dog – non-refundable. Tell them at you are with the dog show and spoke with the manager

Americas Best Value Inn

150 W Ashland St,
Morton, IL 61550
309) 266-9933
\$10 per dog per night, no size limit

RV CAMPING INFORMATION

Carl Spindler Marine & Campground
Marina Lane
East Peoria, IL 61611
309-699-35499

Kamp Komfort RV Park
21408 N 600 East RD
Carlock, IL 61725
309-376-4411

Yogi Bear's Jellystone Park
Goodfield, IL
309-965-2224

DIRECTIONS TO THE TRIAL SITE

See Map Next Page

From the South, St. Louis, MO/Springfield, IL: Merge onto I-55 N toward CHICAGO., Keep Left to take I-155 N via EXIT 127 toward PEORIA/HARTSBURG, Take the IL-9 Exit/Exit 25, toward Pekin/Bloomington., Turn LEFT onto State Route 9/IL-9. Turn right onto Barney Ave., Take 2nd right onto Griffin Ave., Dome will be on Left. Look for "Agility" signs.

From the North, Chicago/Wisc.: Take I-55 south. At exit 163 merge onto I-74 W toward Peoria. Take Exit 101 to merge onto I-155-S toward Lincoln. Take the Broadway Rd exit, Exit 28, Turn Right onto Broadway Rd. Broadway Rd becomes Broadway St., Turn Left onto Veterans Dr, Turn right onto Court Street / IL-9, Turn right onto Barney Ave., Take 2nd right onto Griffin Ave., Dome will be on Left. Look for "Agility" signs.

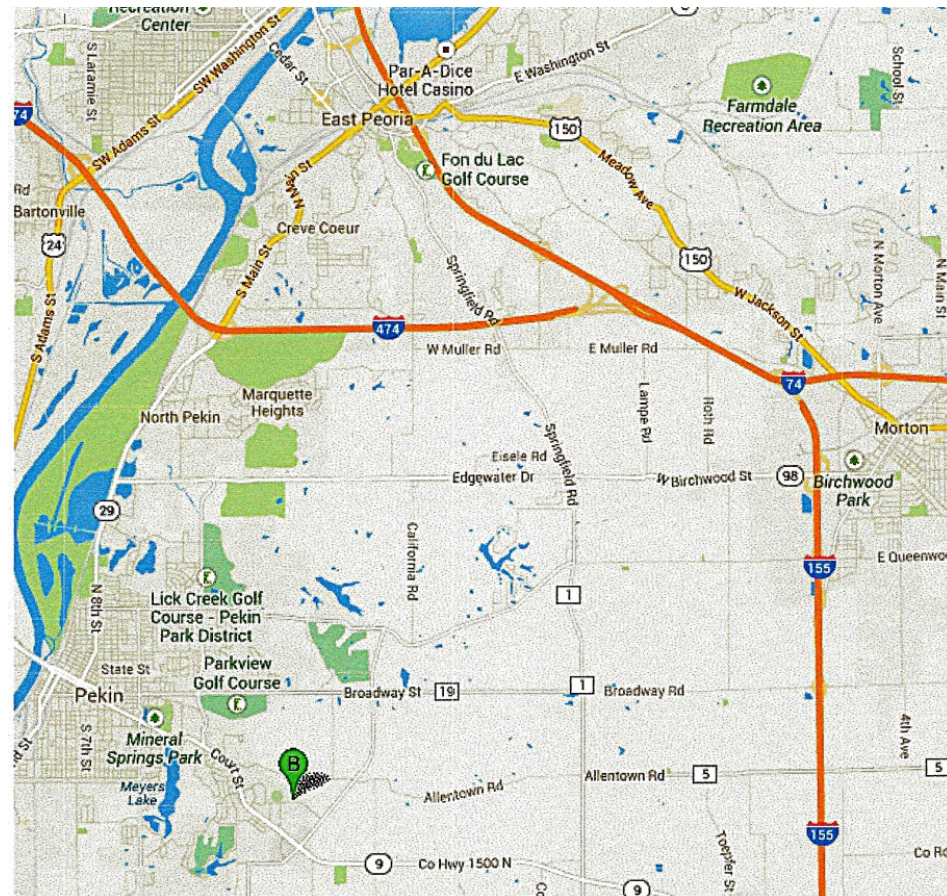

Official Show Photographer

PawPrintPictures

www.PawPrintPictures.com

847-431-4681



**AMERICAN
KENNEL CLUB**

AGILITY TRIAL MOVE-UP FORM

(Do not send this form to AKC. Send it to the Trial Secretary)

USE THIS FORM TO MOVE UP TO A HIGHER AGILITY CLASS ONLY

It is the option of the club to allow day-to-day move-ups. Exhibitors should refer to a club's premium list to verify the club's policy for moving a dog up. If offered, dogs shall be moved up to a higher class at the request of the owner, as a result of the dog qualifying for an agility title.

The request for moving up must be made to the Trial Secretary on or before 6:00 p.m., Monday, September 4, 2017 or 30 minutes before close of trial Friday and Saturday. All move-up entries are subject to availability of the class and payment of any difference in entry fee. Dogs so moved-up will be entered at the end of the running order. Refer to Chapter 1, Section 20 of the Regulations for Agility Trials for additional move-up requirements.

Name of Club	Date
Breed	Sex
Dog's AKC Name	Dog's AKC #

Move Entry to: Agility Class: (Circle One)				Jump Height Division: (Circle One)					
Regular Standard	Open	Excellent	Master	8"	12"	16"	20"	24"	26"
Regular JWW	Open	Excellent	Master	8"	12"	16"	20"	24"	26"
Regular FAST	Open	Excellent	Master	8"	12"	16"	20"	24"	26"
Preferred Standard	Open	Excellent	Master	4"	8"	12"	16"	20"	
Preferred JWW	Open	Excellent	Master	4"	8"	12"	16"	20"	
Preferred FAST	Open	Excellent	Master	4"	8"	12"	16"	20"	

Owners Name: _____

Handlers Name: _____
(If applicable)

**Signature of owner or agent
duly authorized to make this entry:** _____

**Signature of Trial Secretary
If Approved:** _____ **Date:** _____

Time Received: _____

VOLUNTEER SIGN-UP SHEET - POTC

POTC Bucks will be given to all volunteers that you can use to pay for your lunch!
We want to keep things running smoothly so everyone enjoys the trials. If you are willing to assist, please fill out the form below and return it with your entry. Volunteer duties will not interfere with running your dog. Experienced timers, scribes and gate stewards, please volunteer. Training will be provided for those who are inexperienced at their assigned jobs. We will provide lunch to all volunteers. We may need additional workers on Friday because many of our members are working. We would appreciate all the help you could give us. THANKS FROM THE POTC AGILITY TRIAL COMMITTEE!

Please contact Peggy Mooney at volunteers@potcdogs.com or call 309-267-3405 if you have questions about volunteering.

Check	Job	Day Entered		
		Friday	Saturday	Sunday
	Scribe	Friday	Saturday	Sunday
	Timer	Friday	Saturday	Sunday
	Gate Steward	Friday	Saturday	Sunday
	Course Builder	Friday	Saturday	Sunday
	Bar Setter	Friday	Saturday	Sunday
	Leash Runner	Friday	Saturday	Sunday
	Scribe Sheet Runner	Friday	Saturday	Sunday

I am running in the following classes:

Level	# Dogs	Jump Height	Friday	Saturday	Sunday
Novice					
Open					
Excellent					
Master					

Your Name: _____

Phone Number: _____

Email Address: _____

**PLEASE ENCLOSE THIS FORM WITH YOUR ENTRY AND WRITE
"WORKER" ON THE LOWER LEFT SIDE OF ENVELOPE OR EMAIL
PEGGY BEFORE TRIAL TO GET ON SCHEDULE.**

Thank you so much for volunteering.



OFFICIAL AMERICAN KENNEL CLUB AGILITY ENTRY FORM

Peoria Obedience Training Club

Opens: June 16, 2017 • Closes: August 25, 2017

STD JWW FAST T2B PremSTD PremJWW

Table with dates 9/8/2017, 9/9/2017, 9/10/2017 and columns for class types.

Daily Entry Fee: 1st run \$25; -- 2nd, 3rd and 4th run -\$15 each -- 5th and 6th run \$10

Make checks payable to: POTC

Mail to: Le Hayes, 10800 W Brimfield-Jubilee Rd, Princeville, IL 61559

IMPORTANT: Carefully read instructions before filling out! ENTRY FEE ENCLOSED

Choose Either Regular OR Preferred Classes

Circle one jump height | Circle class selections | Only one selection per class (both Master & Premier allowed)

Table comparing Regular and Preferred classes with height options (8", 12", 16", 20", 24", 26" for Regular; 4", 8", 12", 16", 20" for Preferred).

Non-Regular Classes International Sweepstakes STD JWW

ISC Jump Height - Select: 14" 18" 26" or Jump Height Same as Regular/Preferred

Form fields for breed, sex, height at withers, variety, and call name.

AKC® NAME (INCLUDE AKC TITLES ONLY)

Form fields for AKC® NO, ILP NO, PAL NO, FOREIGN REG. NO & COUNTRY, BREEDER, DATE OF BIRTH, and PLACE OF BIRTH.

SIRE

DAM

ACTUAL OWNERS

OWNERS ADDRESS NEW ADDRESS

CITY, STATE ZIP + 4

HANDLER ENTER JR. HANDLER # if applicable

AGREEMENT

I certify that I am the actual owner of the dog, or that I am the duly authorized agent of the actual owner whose name I have entered. In consideration of the acceptance of this entry, I (we) agree to abide by the rules and regulations of The American Kennel Club in effect at the time of this event...

I (WE) AGREE THAT ANY CAUSE OF ACTION, CONTROVERSY OR CLAIM ARISING OUT OF OR RELATED TO THE ENTRY, EXHIBITION OR ATTENDANCE AT THE EVENT BETWEEN THE AKC AND THE EVENT-GIVING CLUB (UNLESS OTHERWISE STATED IN THIS PREMIUM LIST) AND MYSELF (OURSelves) OR AS TO THE CONSTRUCTION, INTERPRETATION AND EFFECT OF THIS AGREEMENT SHALL BE SETTLED BY ARBITRATION PURSUANT TO THE APPLICABLE RULES OF THE AMERICAN ARBITRATION ASSOCIATION.

INSTRUCTIONS

Handlers may opt to enter in a higher height division for all Regular titling classes, but not in a division lower than their proper height division. Dogs entered in the Preferred classes must compete at the required jump height and may not compete in a jump height division higher or lower than their proper height division.

All dogs that have not been officially measured for an Agility Jump Height Card may still compete; however, they must be measured by a Judge of record, an Agility Field Representative, or a Volunteer Measuring Official, prior to running.

Dogs listed in the AKC Canine PartnersSM program may be eligible to enter all-breed AKC agility trials at the club's option. These dogs should be listed as All American Dog and must include their AKC number on the entry form and check the AKC No. box.

Junior Handlers should enter their Junior Handler number on the front of this form. Should you not have your Junior Handler number, it may be obtained from the American Kennel Club (919) 233-9767.

SIGNATURE of owner or his agent duly authorized to make this entry.

SIGN HERE X _____

Telephone Number: _____

Email Address: _____ New

Email

In Case of Emergency - Name: _____ Phone #: _____

AEAGL2 (06/15) a

Exhibitor or owner MUST sign on the signature line beneath the instructions.