

Corrected Premium for the Fees!

ENTRY METHOD: FIRST RECEIVED

ENTRIES WILL OPEN ON March 9, 2018, 7:00am at the Trial Secretary's address. All entries received before this date will be returned. Overnight or certified mail must be sent with the "No Signature Required" waiver signed.

ENTRIES CLOSE ON May 18 2018, 6pm after which time entries cannot be accepted, cancelled, altered, or substituted except as provided for in Chapter 11, Section 6 of the Rules Applying to Dog Shows. Envelopes/transactions containing entries for more than the ten (10) dog maximum and/or entries received prior to the opening date shall be treated as an invalid entry and shall be returned to the sender.

PREMIUM LIST

AKC All-Breed AGILITY TRIALS

This Event is Accepting Entries for All American Dog
Listed in the AKC Canine Partners Program SM

Peoria Obedience Training Club

(Licensed by the American Kennel Club *OR* held by an AKC Member Club)



June 1, 2018 Event # 2018014005

June 2, 2018 Event # 2018014006

June 3, 2018 Event # 2018014007



Avanti's Dome & Sports Center

3401 Griffin Avenue
Pekin, IL 61554

ENTRY LIMITS

Friday – 350 runs per judge for a total of 700 runs per day

Saturday & Sunday – 350 runs per judge for a total of 700 runs per day

Indoors On Soccer Turf: Both Rings are 110 x 110

POTC BUCKS given to workers!!

Trial Hours: Friday, Saturday & Sunday – 7:00 am to one hour after last run

Judges:

Ron McClelland, Baltimore, Ohio, #70507

Jean Munger, VMO, Hampshire, Il # 16326



**American
Kennel Club®**

CERTIFICATION Permission has been granted by the American Kennel Club for the holding of this event under the American Kennel Club rules and regulations.

GINA M. DINARDO, Executive Secretary

OFFICERS OF PEORIA OBEDIENCE TRAINING CLUB

President..... Jill Williamson
 Secretary Dawn Noe
 Vice President.....Linda Brillion
 Treasurer.....Deyonne Hinderliter

TRIAL CHAIRPERSON	TRIAL SECRETARY
Roxanne Minor 3317 E Alvard Ln Chillicothe, IL 61523 - 309-678-7398 RoxMinor1@Frontier.com	Le Hayes 10800 W Brimfield-Jubilee Rd Princeville, IL 61559 (309) 243-8652 LeHayes3@aol.com
Assistant Trial Chairperson	
Nancy Affolter -208 Burning Tree Dr - Pekin IL 61554 - 309 992-8700 - bhanancy@hotmail.com	

EVENT COMMITTEE

*Roxanne Minor, Nancy Affolter, Linda Doerfler, Diane Bader, Linda Brillion, Vickie Gordon, Le & Nancy Hayes
 Public Relations ... Linda Locke*

JUDGES AND ASSIGNMENTS

Ron McClelland #70507 3183 Basil Western Road Baltimore, Ohio43105 Friday: Ring One Saturday: Ring Two Sunday: Ring One	Jean Munger #16326, VMO 47W656 SHIREWOOD FARM RD Hampshire, Il 60140 Friday: Ring Two Saturday: Ring One Sunday: Ring Two
--	--

VETERINARIAN ON CALL (OR IN ATTENDANCE)

Tri-County Animal Emergency Clinic
 1800 N Sterling Ave
 Peoria, IL 61604
 309-672-1565

Exhibitors should follow their veterinarian's recommendations to assure their dogs are free of internal and external parasites, any communicable diseases, and have appropriate vaccinations.

EMERGENCY SERVICES

Tazwell County 911

CLASSES OFFERED – Regular and Preferred - JUDGING START TIMES Friday, Saturday and Sunday

Ring One – 8 am T2B All Standard – Premier Standard – Excellent/Master Standard – Open Standard-Novice	Ring Two – 8:45 am FAST – Novice FAST - Open FAST - Masters/Excellent JWW – Novice JWW - Open JWW - Excellent/Masters Premier JWW
--	---

Judging to begin at 8 a.m in Ring 1 and 8:45 in Ring 2

Please consult the AKC Regulations for Agility Trials for a complete description and eligibility for entry into these classes. The exhibitor is fully responsible for entering the dog in the correct class(es)/height divisions. Dogs running in a lower height division than they are eligible for will be eliminated.

HEIGHT DIVISIONS

REGULAR

Handlers may opt to run their dog in a higher height division.

8"
12"
16"
20"
24"
26"

PREFERRED

Handlers must run their dog in their proper eligible height.

4"
8"
12"
16"
20"
n/a

HEIGHT AT WITHERS

Owners are responsible for entering their dog in the proper height division.

For dogs 11 inches and under at the withers
 For dogs 14 inches and under at the withers
 For dogs 18 inches and under at the withers
 For dogs 22 inches and under at the withers
 For dogs over 22 inches at the withers
 Dogs may be entered at this height at their owner's discretion

MEASURING and HEIGHT CARD INFORMATION

Effective January 1, 2010, exhibitors are no longer required to provide proof to Trial Secretaries that their dog has a valid jump height card as part of the check-in process. Furthermore, this change eliminates the need for a copy of the jump height card to be submitted with an entry form. Dogs without a valid Jump Height Card/Form may still compete; but they must be measured/wicketed by the **Judge of Record** PRIOR to running in their class and this measurement will be valid for that weekend of trials only. The exception to this requirement is a dog entered in the 24" or 26" height division. However, if a **Volunteer Measuring Official (VMO)** or an **Agility Field Rep** is present; **ALL** dogs without a valid Jump Height Card/Form must be measured at some time during the trial or cluster of trials. This does not preclude having the dog wicketed by the Judge of Record if the VMO or Rep is not available to measure the dog *before* its first run of the trial or cluster of trials. It is the exhibitor's responsibility to have their dog measured prior to running and failure to do so will result in the cancellation of any qualifying scores.

NEW Simplified Jump Height Card Process

When filling out the entry form, there is a new section at the top of the form for exhibitors to designate whether your dog needs to be officially measured. Please check the box so that the Trial Secretary knows whether to include your dog on the *Dogs To Be Measured List*. It is no longer required that you submit a copy of your dog's jump height card with your entry form or show it during day of show check-in.

DOG ELIGIBLE TO ENTER

This trial is open to all dogs fifteen (15) months of age or older that are registered with the American Kennel Club or that have AKC Limited Registration, Purebred Alternative Listing/Indefinite Listing Privileges (PAL/ILP), an AKC Canine Partners listing number, or approved Foundation Stock Service (FSS) breeds are eligible to participate.

Dogs with a Purebred Alternative Listing/Indefinite Listing Privileges (PAL/ILP) or an AKC Canine Partners listing number must be spayed or neutered in order to compete. Wherever the word "dog" is used in these regulations it includes both sexes.

Dogs should be physically sound. Dogs that are blind shall not be eligible, and neither are bitches in season, aggressive dogs, or dogs suffering from any deformity, injury, or illness which may affect the dog's physical or mental performance. No dog shall compete if it is taped or bandaged in any way or has anything attached to it for medical purposes. Refer to Chapter 2 of the Registration and Discipline Rules for the listing of registerable breeds that may participate. Puppies under four (4) months of age are strictly prohibited from the trial grounds.

OBSTACLES AND RING CONDITIONS

Obstacles will meet the specifications for obstacles in the current edition of the Regulations for Agility Trials. All classes will take place indoors on a Soccer Turf. Ring sizes will be 110 x 110. (*Exact size*)

ENTRY FEES PER DAY

First entry of each dog (includes a \$3.50 AKC recording fee).....	\$25.00
Second entry of same dog (includes a \$3.00 AKC recording fee).....	\$15.00
Third entry of same dog (includes a \$3.00 AKC recording fee)	\$15.00
Fourth entry of same dog(includes a \$3.00 AKC recording fee).....	\$15.00
Fifth entry of same dog(includes a \$3.00 AKC recording fee).....	\$15.00

If you would like to know the status of your entry prior to the issuance of the judging schedule upon closing, please enclose a self-addressed, stamped envelope or postcard along with your entry. E-mail confirmations will be sent to those listing a legible e-mail address on the entry form.

Mail entry forms and fees to: Le Hayes, Trial Secretary, 10800 W Brimfield-Jubilee Rd, Princeville, IL 61559. Please make checks payable to POTC. No entries will be accepted by phone, fax or hand delivery. Express mail entries must include the signature waiver allowing them to be left at the secretary's address. Inquiries may be directed to Le Hayes at LeHayes3@aol.com. No entry shall be made and no entry shall be accepted which specifies any conditions as to its acceptance.

Illegible entries will not be processed and will be returned to the exhibitor. Returned checks do not constitute a valid entry and the Trial Secretary will add a **\$20** collection fee to the amount of each returned check.

Peoria Obedience Training Club is accepting online entries through the www.LabTestedOnline.com. During the first 48 hours after opening, the initial limit of entries will be designated as follows: Online entries: 250; Paper entries:450. If either form of entry has not filled at the end of the 48 hour time period, the club reserves the right to decrease or increase either the online or paper limits accordingly. No hand deliveries will be accepted in the first twenty-four hours following the opening date and time.)

COURSE WALK-THROUGHS AND WARM-UP INFORMATION

Handlers in all classes are permitted to walk the course, without a dog, during a walk-through period held prior to the start of the class. The walk-through is restricted to handlers entered in that class only. Handlers with multiple dogs, at events with multiple rings may request to walk with a height group other than the one their dog is entered in if a conflict is imminent.

A warm-up area, consisting of a regulation agility jump, may be provided for exhibitors. The warm-up area is to be used exclusively for warming up the dog and not for training or relieving of the dog.

RIBBONS, AWARDS, AND PRIZES

Rosettes will be awarded in each jump height division in each class as follows:

First Place.....	Blue
Second Place.....	Red
Third Place.....	Yellow
Fourth Place.....	White
Qualifying Score.....	Dark Green

A New Title rosette will be awarded to all dog and handler teams finishing a title. A MACH rosette and decorated MACH bar will be awarded to all dog and handler teams that attain their MACH.

All exhibitors should obtain a copy of the Regulations for Agility Trials by downloading them from the American Kennel Club website at <http://www.akc.org/rules/>.

NOTICE TO EXHIBITORS

SAFETY, BEHAVIOR and LIABILITY

The safety of the dog is our primary concern. By entering this trial, exhibitors acknowledge that they are familiar with the rules and regulations of this sport, and that their dogs are familiar with and able to perform all obstacles safely.

It is expressly understood that exhibitors alone are responsible for the behavior of their dogs and/or children. Any exhibitor whose dogs and/or children create an unnecessary disturbance or repeatedly engage in unsafe or disruptive behavior may, at the discretion of the trial committee, be asked to leave the show site. In such case, no refund of any fees paid will be made. The Peoria Obedience Training Club and its agents, employees, etc., will assume no responsibilities for any loss, damage or injury sustained by exhibitors or handlers, or to any of their dogs or property and further assumes no responsibility for injury to children. The Peoria Obedience Training Club reserves the right to decline entries for cause and may remove any dog on account of aggression. No one shall have any recourse or claim against the Peoria Obedience Training Club or any official thereof.

All dogs must be on leash at all times when on trial grounds except when in the designated warm-up area or competing on the course.

REFUNDS

No entry fee will be refunded if the trial cannot open or be completed by reason of riots, civil disturbances, fire, an act of God, public emergency, act of a public enemy, or any other cause beyond the control of the organizing committee. No entry fee will be refunded in the event a dog is absent, disqualified, excused, or barred from competition by the action of the Trial Committee.

Bitches in season are not permitted to compete in Agility Trials. As such, the club will refund entry amount less AKC fees per day of the entry fee paid for bitches unable to compete for this reason upon presentation of a veterinarian certificate after the closing date. This certificate must be presented to the Trial Secretary prior to the start of judging on the first day of the trial or cluster of trials. Any withdrawals for dog injury or heat cycle after closing date, entry fees will be refunded less AKC fees after presentation of a veterinarian certificate before start of trial.

RINGSIDE

Dogs may arrive any time prior to judging if the dog has a valid temporary or permanent jump height card. Otherwise, they must be available for measuring prior to the start of their class if a VMO or AKC Field Rep is available to measure dogs. All dogs not needed for further judging will be excused.

Judges are not required to wait for dogs. The Owner of each dog is solely responsible for having it ready at ringside when it is to be judged. The Club has no responsibility for providing service through a public address system or stewards or runners for the purpose of calling or locating dogs that are not brought into the ring when required.

CATALOGS

Advance catalog sales may be ordered and prepaid on your entry form for **\$10** A limited number of catalogs will be available for sale at the trial site for a cost of **\$10**. Running order sheets will be available to all exhibitors at no charge.

VENDORS

If you would like a vendor space, please contact Nancy Affolter at 309 992-8700 or bhanancy@hotmail.com for more information.

This club does not agree to arbitrate claims as set forth on the Official AKC Entry Form for this event. Proof of insurance is required.

ADDITIONAL SITE INFORMATION

Crating space: Ample crating will be directly behind the agility rings however, POTC and the Avanti's Dome will not be responsible for any lost or damaged items left at the show site. You can bring in your your equipment through the back overhead door entrance. Those doors are to be operated by Avanti's personnel **only**. Front entry through revolving door throughout the day.

A full service food concession is available on the site. The Sports Arena asks that no food be brought into the facility. Dog treats are allowed. There are several restaurants and fast food vendors within a 3 miles driving distance. You will be able to trade your POTC Bucks toward your lunch at the concession stand or use them for discounts on future POTC entries.

Overnight or RV Parking is available. **PLEASE NOTE:** There is **no electrical service for large motor homes** at this facility. RV parking is not restricted to a particular area. Showers are not available onsite.

Exhibitors are responsible for cleaning up after their dog(s). Any exhibitor failing to do so may be excused without benefit of refund if the Event Committee deems the exhibitor to be in violation of this requirement. Cleaning supplies and disposal sites will be available at various locations around the show grounds.

Special arrangements can be made with Roxanne Minor at RoxMinor1@Frontier.com - 309-678-7398 to set up Thursday June 8, 2018. You must contact her to make arrangements. The building will be open to exhibitors at 6:30 AM Friday 6/9/17. Self-service check in will begin at 7:00 all days. Class judging will begin no earlier than 8:00 AM.

Exact running order will be determined after entries close and will be provided in the Judging Program. There will be one half hour difference in start time between rings. This set of trials uses electronic timers.

Entries **will not be accepted** without signature, fees and back of entry form with agreement signed, nor will credit cards or faxed entries be accepted. Online entries at www.LabTestedOnline.com are accepted.

POTC and Avanti's Dome & Sports Center **will not be responsible** for the loss of or damage to any dog exhibited, or for damage to possessions of any exhibitor, whether the result of an accident or any other cause. It is distinctly understood that every dog at this show is in the care and custody of its owner or handler during the entire time the dog is in the trial buildings or on the grounds of the Avanti's Dome & Sports Center. The welfare of an exhibitor's child is assumed to be the responsibility of the exhibitor. It is distinctly understood that exhibitors will exercise control and restraint over their children.

Exhibitors should follow their veterinarian's recommendations to assure their dogs are free of internal and external parasites, any communicable diseases and have appropriate vaccinations. Exhibitors may wear shirts or insignia of their training group.

HOTEL INFORMATION

These hotels have graciously agreed to accept our well-mannered dogs. A pet deposit may be required. Please check with hotels for policies and restrictions.

Pekin area Motels

ECONO LODGE SUITES

3242 Vandever Avenue
Pekin, IL 71554
309-353-4047

\$20 for up to 5 dogs per room if you mention POTC

Holiday Inn Express, 3615 Kelly Ave, Pekin, Il 61554, 1-866-238-4218

1 mile from Avanti's Sports Dome – Be sure to mention that you are with the dog show!

Morton Area Motels (North) I-155 to I-74 East

Approximately 15 miles

Days Inn Morton, Il

101 E Ashland Street
Morton, IL 61550
309-266-1600

Pet fee \$5 per dog - non-refundable Tell them that you are with the dog show and spoke with the manager.

Quality Inn

115 E. Ashland Street
Morton, IL 61550
309-266-8310

Exit 102 off I-74 non refundable
One time Pet fee \$15 per 2 dogs - non-refundable Tell them that you are with the dog show.

Americas Best Value Inn

150 W Ashland St,
Morton, IL 61550
309) 266-9933

\$10 per dog per night
No size limit

RV CAMPING INFORMATION

Carl Spindler Marine & Campground Marina Lane East Peoria, IL 61611 309-699-3549	Kamp Komfort RV Park 21408 N 600 East RD Carlock, IL 61725 (309) 376-4411	Yogi Bear's Jellystone Park Goodfield, Illinois (309) 965-2224
--	---	---

DIRECTIONS TO THE TRIAL SITE

From the South, St. Louis, MO/Springfield, IL: Merge onto I-55 N toward CHICAGO., Keep Left to take I-155 N via EXIT 127 toward PEORIA/HARTSBURG, Take the IL-9 Exit/Exit 25, toward Pekin/Bloomington., Turn LEFT onto State Route 9/IL-9. Turn right onto Barney Ave., Take 2nd right onto Griffin Ave., Dome will be on Left. Look for "Agility" signs.

From the North, Chicago/Wisc.: Take I-55 south. At exit 163 merge onto I-74 W toward Peoria. Take Exit 101 to merge onto I-155-S toward Lincoln. Take the Broadway Rd exit, Exit 28, Turn Right onto Broadway Rd. Broadway Rd becomes Broadway St., Turn Left onto Veterans Dr, Turn right onto Court Street / Il-9, Turn right onto Barney Ave., Take 2nd right onto Griffin Ave., Dome will be on Left. Look for "Agility" signs.

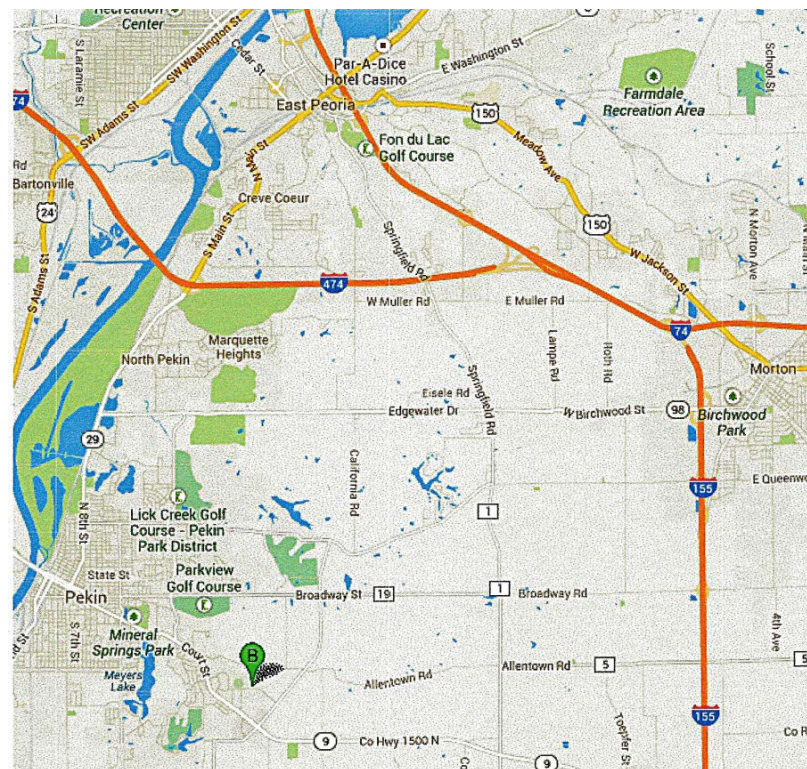

Our official Show Photographer will Be:
Kathleen Schaffer Of PupArt
P.O. Box 1446
Frankfort, Il 60423
www.pupart.com



AGILITY TRIAL MOVE-UP FORM

(Do not send this form to AKC. Send it to the Trial Secretary)

USE THIS FORM TO MOVE UP TO A HIGHER AGILITY CLASS ONLY

It is the option of the club to allow day-to-day move-ups. Exhibitors should refer to a club's premium list to verify the club's policy for moving a dog up. If offered, dogs shall be moved up to a higher class at the request of the owner, as a result of the dog qualifying for an agility title.

The request for moving up must be made to the Trial Secretary according to the club's published policy. All move-up entries are subject to availability of the class and payment of any difference in entry fee. Dogs so moved-up will be entered at the end of the running order. Refer to Chapter 1, Section 20 of the Regulations for Agility Trials for additional move-up requirements.

Name of Club	Date
Breed	Sex
Dog's AKC Name	Dog's AKC #

Move Entry to:				Jump Height Division: (Circle One)					
Agility Class: (Circle One)									
Regular Standard	Open	Excellent	Master	8"	12"	16"	20"	24"	26"
Regular JWW	Open	Excellent	Master	8"	12"	16"	20"	24"	26"
Regular FAST	Open	Excellent	Master	8"	12"	16"	20"	24"	26"
Preferred Standard	Open	Excellent	Master	4"	8"	12"	16"	20"	
Preferred JWW	Open	Excellent	Master	4"	8"	12"	16"	20"	
Preferred FAST	Open	Excellent	Master	4"	8"	12"	16"	20"	

Owners Name: _____

Handlers Name: _____
(If applicable)

Signature of owner or agent
duly authorized to make this entry: _____

Signature of Trial Secretary
If Approved: _____ **Date:** _____

Time Received: _____

VOLUNTEER SIGN-UP SHEET - POTC

We are giving \$2 Potc Bucks for each class that you volunteer to help with! POTC Bucks may be used for future runs, and/or for lunch at Avanti's concession stand. We want to keep things running smoothly so everyone enjoys the trials. If you are willing to assist, please fill out the form below and return it with your entry. Volunteer duties will not interfere with running your dog. Experienced timers, scribes and gate stewards, please volunteer. Training will be provided for those who are inexperienced at their assigned jobs. We may need additional workers on Friday because many of our members are working. We would appreciate all the help you could give us. THANKS FROM THE POTC AGILITY EVENT COMMITTEE!

Please contact Roxanne Minor at roxminor1@frontier.com or call 309-678-7398 if you have questions about volunteering.

Check	Job	Day Entered		
		Friday	Saturday	Sunday
	Scribe	Friday	Saturday	Sunday
	Timer	Friday	Saturday	Sunday
	Gate Steward	Friday	Saturday	Sunday
	Course Builder	Friday	Saturday	Sunday
	Bar Setter	Friday	Saturday	Sunday
	Leash Runner	Friday	Saturday	Sunday
	Scribe Sheet Runner	Friday	Saturday	Sunday
	Chute Straightener	Friday	Saturday	Sunday

I am running in the following classes:

Level	# Dogs	Jump Height	Friday	Saturday	Sunday
Novice					
Open					
Excellent					
Master					

Your Name: _____

Phone Number _____

Email Address _____

PLEASE ENCLOSE THIS FORM WITH YOUR ENTRY AND WRITE "WORKER" ON THE LOWER LEFT SIDE OF ENVELOPE OR EMAIL PEGGY BEFORE TRIAL TO GET ON SCHEDULE.



OFFICIAL AMERICAN KENNEL CLUB AGILITY ENTRY FORM

Peoria Obedience Training Club

Opens: March 9, 2018: • Closes: May 18, 2018

Table with dates (6/1/2018, 6/2/2018, 6/3/2018) and checkboxes for class types (STD, JWW, FAST, T2B, PremSTD, PremJWW).

Daily Entry Fee: 1st run \$25 \$15 each additional run

Make checks payable to: POTC Mail to: Le Hayes, 10800 W Brimfield-Jubilee Rd, Princeville, IL 61559

IMPORTANT: Carefully read instructions before filling out! ENTRY FEE ENCLOSED

Choose Either Regular OR Preferred Classes

Circle one jump height | Circle class selections | Only one selection per class (both Master & Premier allowed)

Table with columns for Regular Classes (8", 12", 16", 20", 24", 24C") and Preferred Classes (4", 8", 12", 16", 20") and rows for STD, JWW, FAST, T2B.

Non-Regular Classes International Sweepstakes []STD []JWW

Form fields: This Dog Needs To Be Measured []Yes []No, BREED, VARIETY, CALL NAME, HEIGHT AT WITHERS.

AKC® NAME (INCLUDE AKC TITLES ONLY)

Form fields: AKC® NO [], Enter Complete Registration # below, DATE OF BIRTH, ILP NO. [], PAL NO. [], PLACE OF BIRTH (LIST COUNTRY), FOREIGN REG. NO & COUNTRY [], BREEDER.

SIRE

DAM

ACTUAL OWNERS

OWNERS ADDRESS [] NEW ADDRESS

CITY, STATE ZIP + 4

HANDLER ENTER JR. HANDLER # if applicable

Exhibitor or owner MUST sign on the signature line beneath the instructions.

AKC Rules, Regulations, Policies and Guidelines are available on the American Kennel Club Web site, www.akc.org.

AGREEMENT

I certify that I am the actual owner of the dog, or that I am the duly authorized agent of the actual owner whose name I have entered. In consideration of the acceptance of this entry, I (we) agree to abide by the rules and regulations of The American Kennel Club in effect at the time of this event, and any additional rules and regulations appearing in the premium list of this event and entry form and any decision made in accord with them.

Additionally, I (we) hereby assume the sole responsibility for and agree to indemnify, defend and save the aforementioned parties harmless from any and all loss and expense (including legal fees) by reason of the liability imposed by law upon any of the aforementioned parties for damage because of bodily injuries, including death at any time resulting therefrom, sustained by any person or persons, including myself (ourselves), or on account of damage to property, arising out of or in consequence of my (our) participation in this event, however such, injuries, death or property damage may be caused, and whether or not the same may have been caused or may be alleged to have been caused by the negligence of the aforementioned parties or any of their employees, agents, or any other person.

INSTRUCTIONS

Handlers whose dogs measure into the 8" through 20" regular jump height divisions may opt to enter in a higher or 24-choice height division for all Regular titling classes, but not in a division lower than their proper height division.

All dogs that have not been officially measured for an Agility Jump Height Card may still compete; however, they must be measured by a Judge of record, an Agility Field Representative, or a Volunteer Measuring Official, prior to running.

Dogs listed in the AKC Canine PartnersSM program may be eligible to enter all-breed AKC agility trials at the club's option. These dogs should be listed as All American Dog and must include their AKC number on the entry form and check the AKC No. box.

Junior Handlers should enter their Junior Handler number on the front of this form. Should you not have your Junior Handler number, it may be obtained from the American Kennel Club (919) 233-9767. If the Junior Handler is not the owner of the dog identified on the face of this form, what is the relationship of the Junior Handler to the Owner?

SIGNATURE of owner or his agent duly authorized to make this entry.

SIGN HERE X _____

Telephone Number: _____

Email Address: _____ [] New Email

In Case of Emergency - Name: _____ Phone #: _____